

**LEGEND - KEY**

- RESERVATION LOTS CONNECTED TO INFRASTRUCTURE GRID (150' LOTS AVG 1/3 OF AN ACRES)
- RESERVATION GREEN ZONE LOTS (INDIVIDUAL LOT OF INFRASTRUCTURE GRID (50' LOTS AVG 1/3 ACRES))
- ARCHAEOLOGICAL RESERVE (APPROX. 23.52 ACRES)
- RESERVED FOR COMMERCIAL DEVELOPMENT
- REC RECREATIONAL / GREEN SPACE
- RESERVED FOR PARKING
- RED MANGROVE RESERVE (APPROX. 14 ACRES)
- BODY OF WATER / CANAL
- LOW IMPACT 2 RED TRIMBER COTTAGE (SUPPORTING ON THE EDGE OF MANGROVE RESERVE) (EACH WITH INDIVIDUAL PASSAGE DRAGGAGE SYSTEM)
- RESTAURANT
- WELCOME CENTER
- PROPOSED LOCATION OF WELL
- GOLF CART ACCESS TRAIL
- DEVELOPMENT ROAD
- MANGROVE OBSERVATION DECK
- ARCHAEOLOGICAL FEATURE 1 - TWO ATTACHED HOUSES SIMILAR IN SIZE (EACH APPROX. 53.8FT X 48FT AT THE BASE AND 7.5FT TALL)
- ARCHAEOLOGICAL FEATURE 2 - SINGLE HOUSE (20.8FT X 19.7FT AT THE BASE AND 9.5FT TALL)
- ARCHAEOLOGICAL FEATURES 3, 4, 5 & 6 - SMALL LOW RING HOUSES
- ARCHAEOLOGICAL FEATURE 7 - BOTTLE FROM COLOMBIA PERIOD (LOGGED BY SMALL SAPOCILA TREE) (19.7FT X 4.2FT AT THE BASE, 4.9FT TALL)
- ARCHAEOLOGICAL FEATURE 8 - SMALL PLAZA (4.0FT X 4.0FT HIGH PLATFORM BASE (MEASURING 12.4FT X 12.4FT) WITH TALLEST HOUSE (19.7FT X 4.2FT AT THE BASE, 4.9FT TALL)

**PHASE 2 - ZONING**

- RESERVED FOR CONDO DEVELOPMENT
- RESERVED FOR RESIDENTIAL DEVELOPMENT
- RESERVED FOR BOUTIQUE HOTEL & WELLNESS FACILITIES
- ARCHAEOLOGICAL RESERVE
- RESERVED FOR COMMERCIAL DEVELOPMENT
- RESERVED FOR REC RECREATIONAL / GREEN SPACE
- RESERVED FOR SOLAR FIELD
- RESERVED FOR SITE DRAINAGE
- RESERVED FOR FUTURE DEVELOPMENT

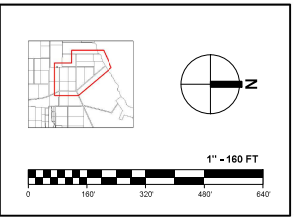
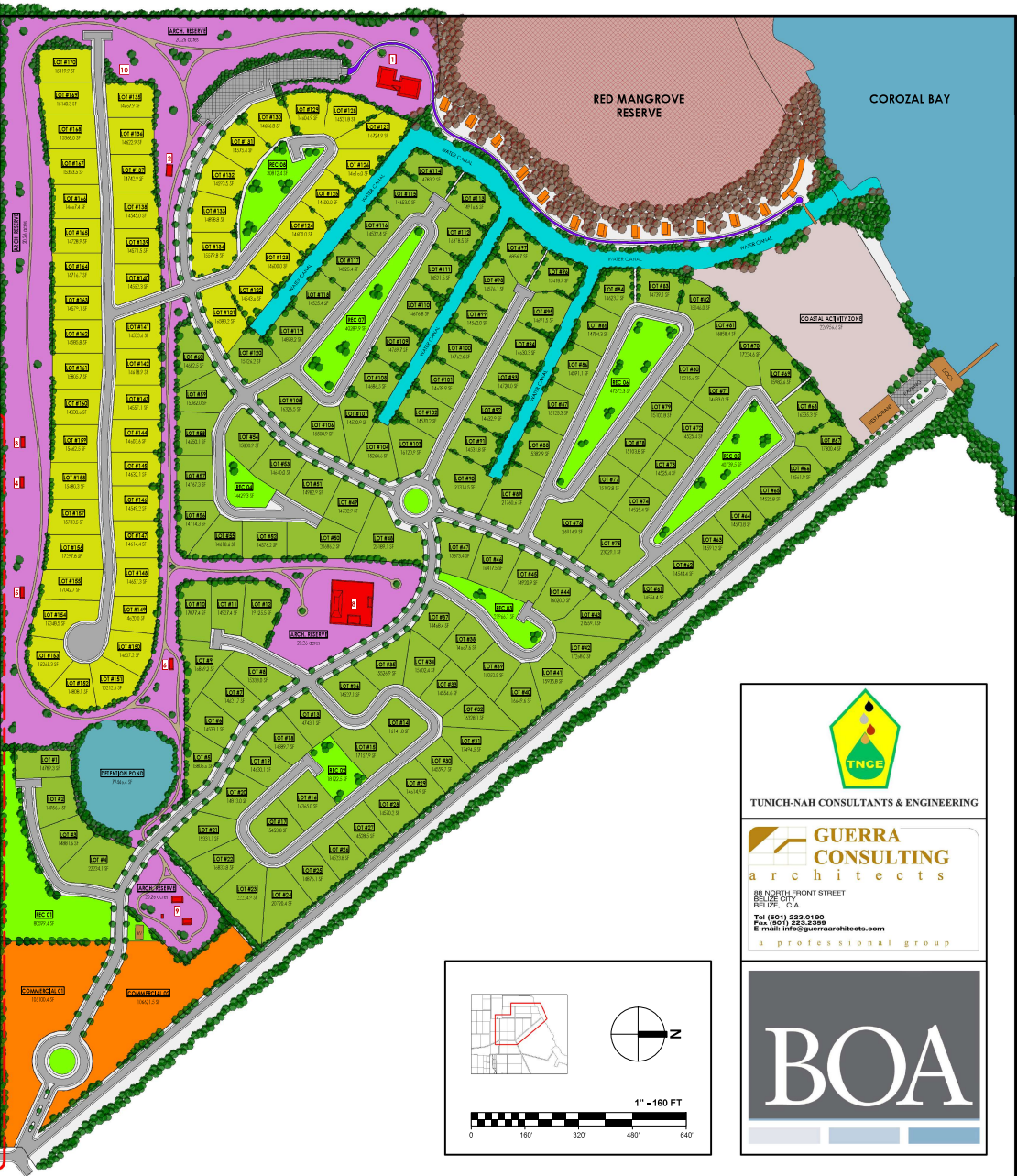
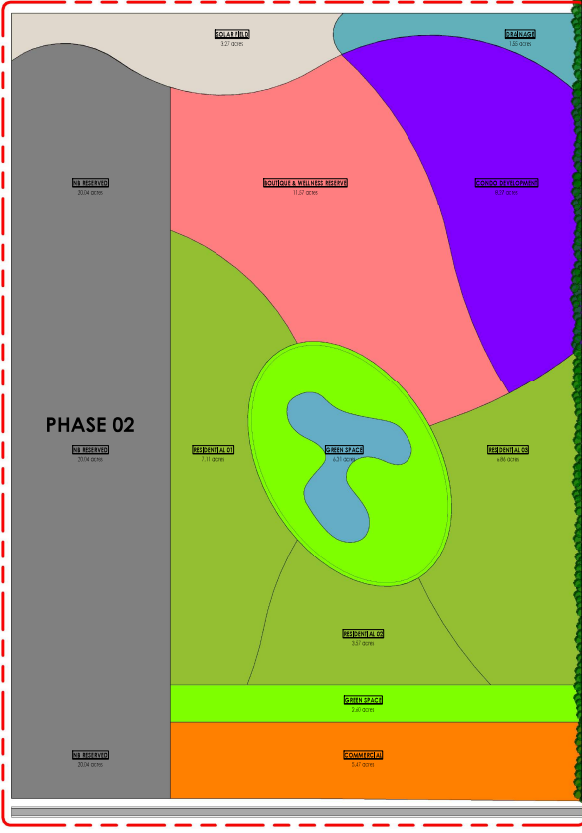



**TUNICH-NAH CONSULTANTS & ENGINEERING**

---



**GUERRA CONSULTING architects**

818 NORTH FRONT STREET  
BELIZE CITY, BELIZE, C.A.

Tel: (501) 223-0190  
Fax: (501) 223-3999  
E-mail: info@guerraarchitects.com

a professional group

---



**BOA**

**ESCAPE TO BELIZE - MASTER SITE PLAN - (PRESENTATION PLAN)**